

GE 7 230/CEE
110/CEE

ETL-Nr. 458.740 Blatt 1

Stand 06-2021

status-date 06-2021

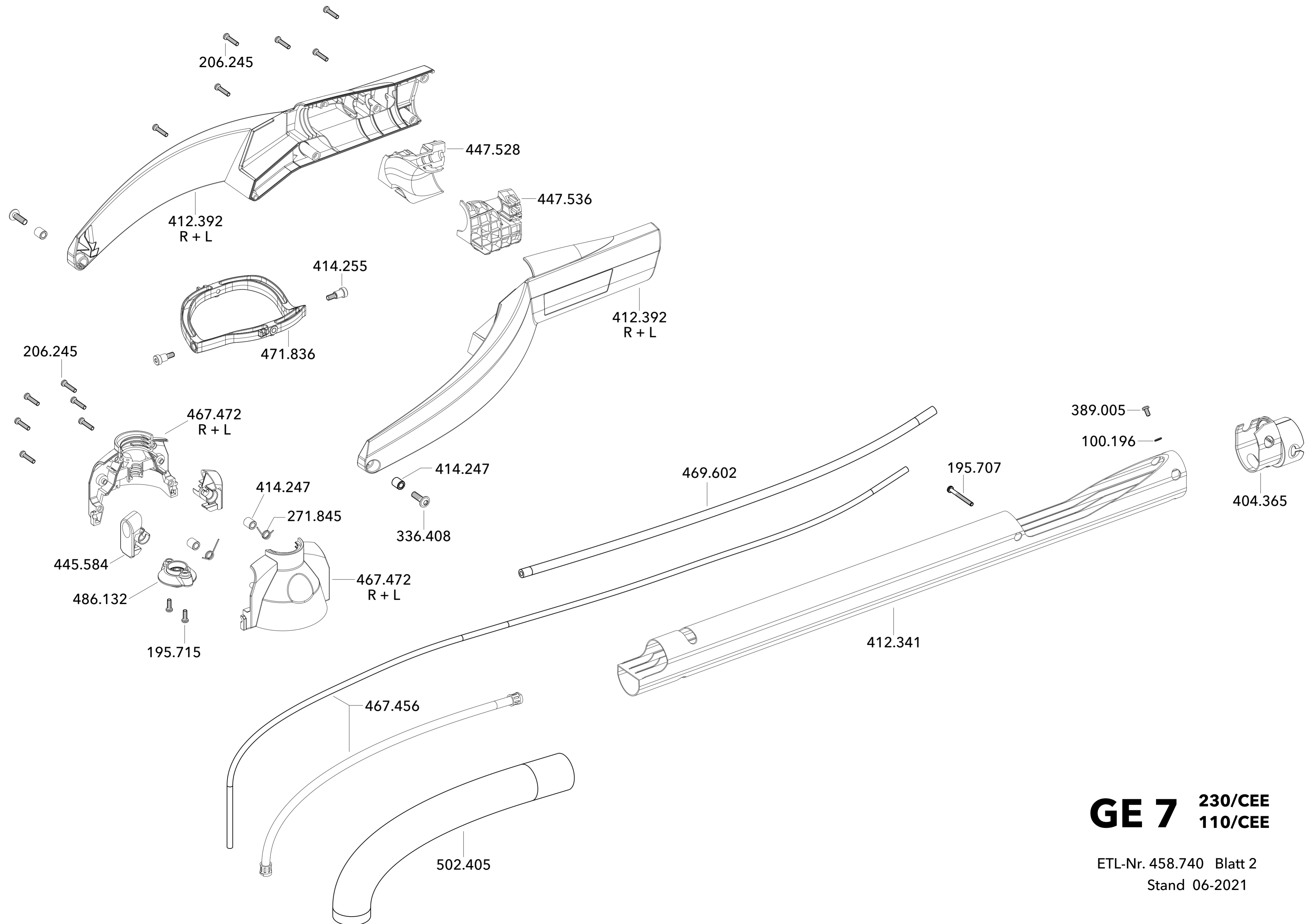

GE 7 230/CEE
110/CEE

ETL-Nr. 458.740 Blatt 2
Stand 06-2021

MH-R D225

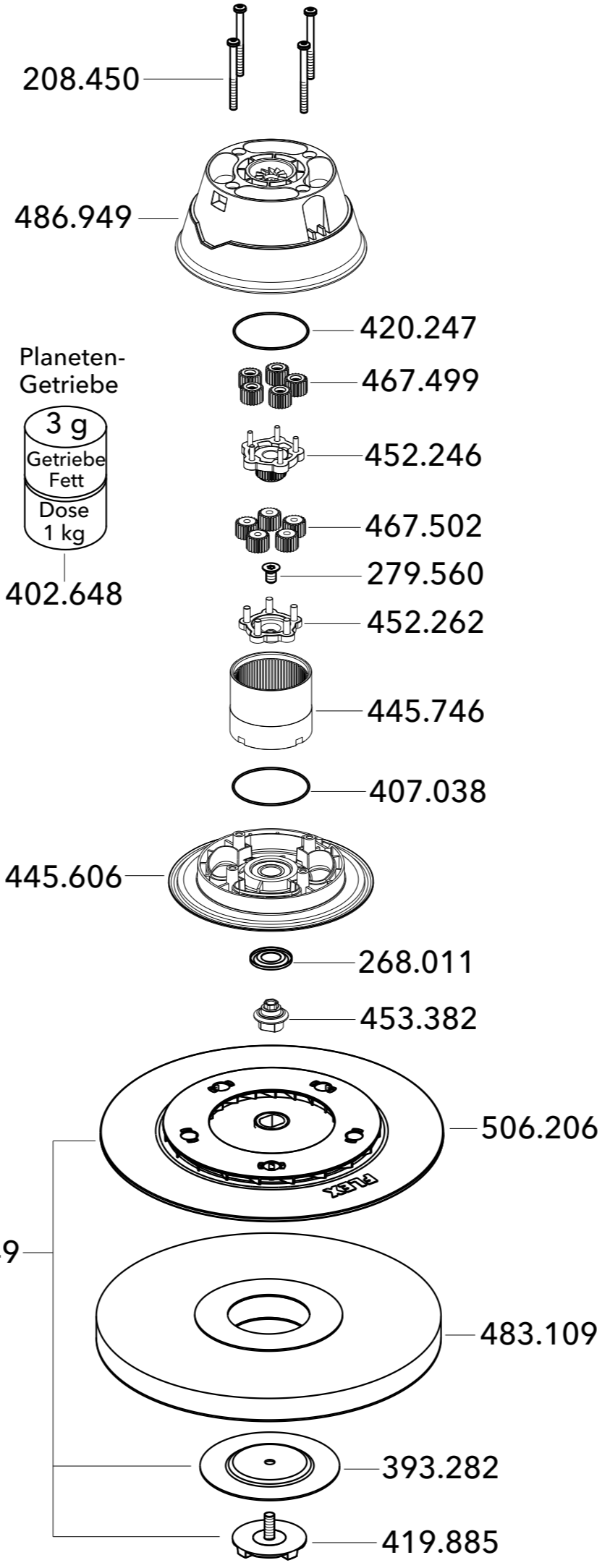
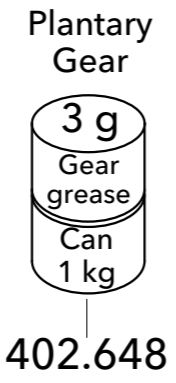
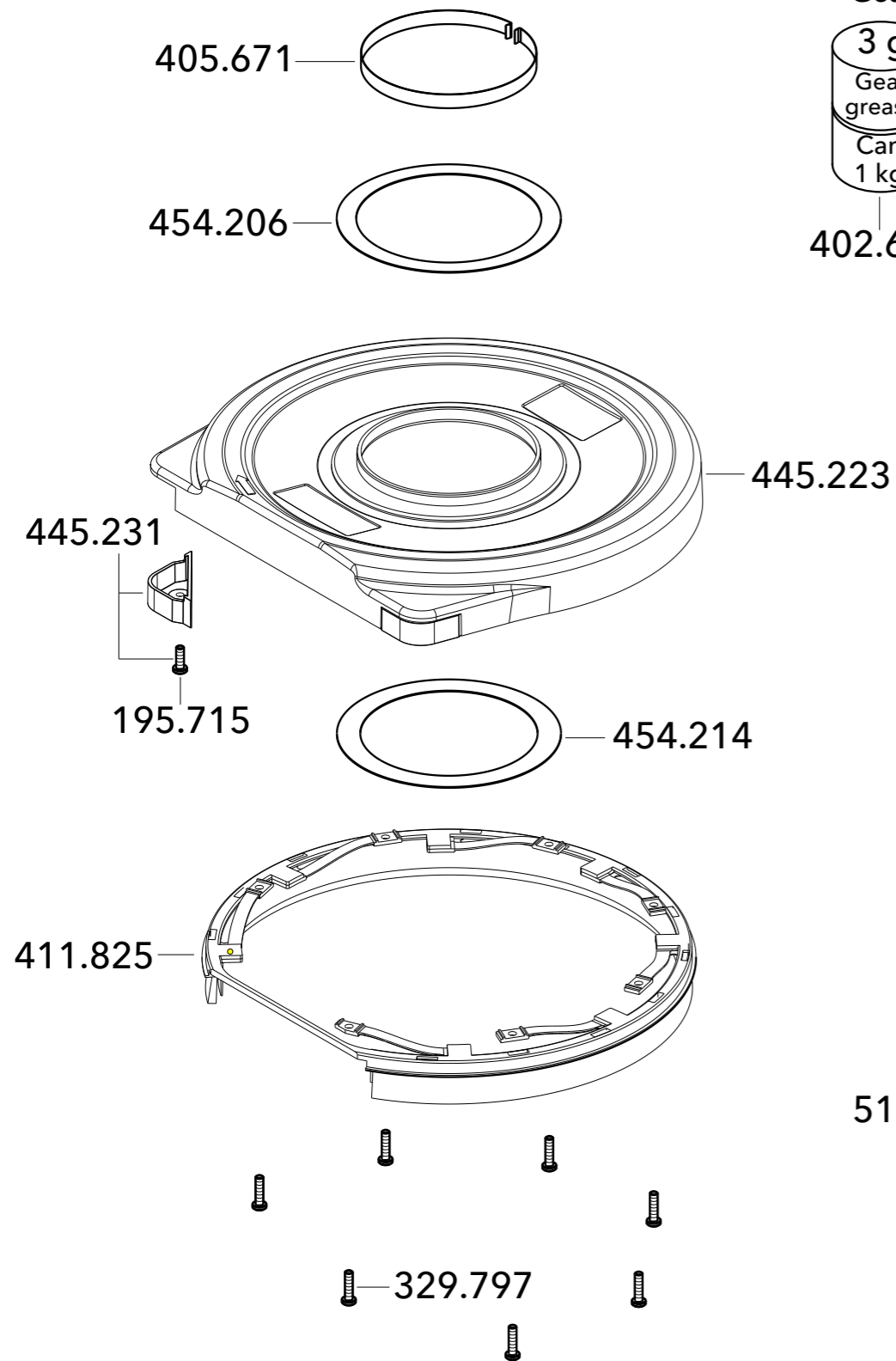

MH-O D225

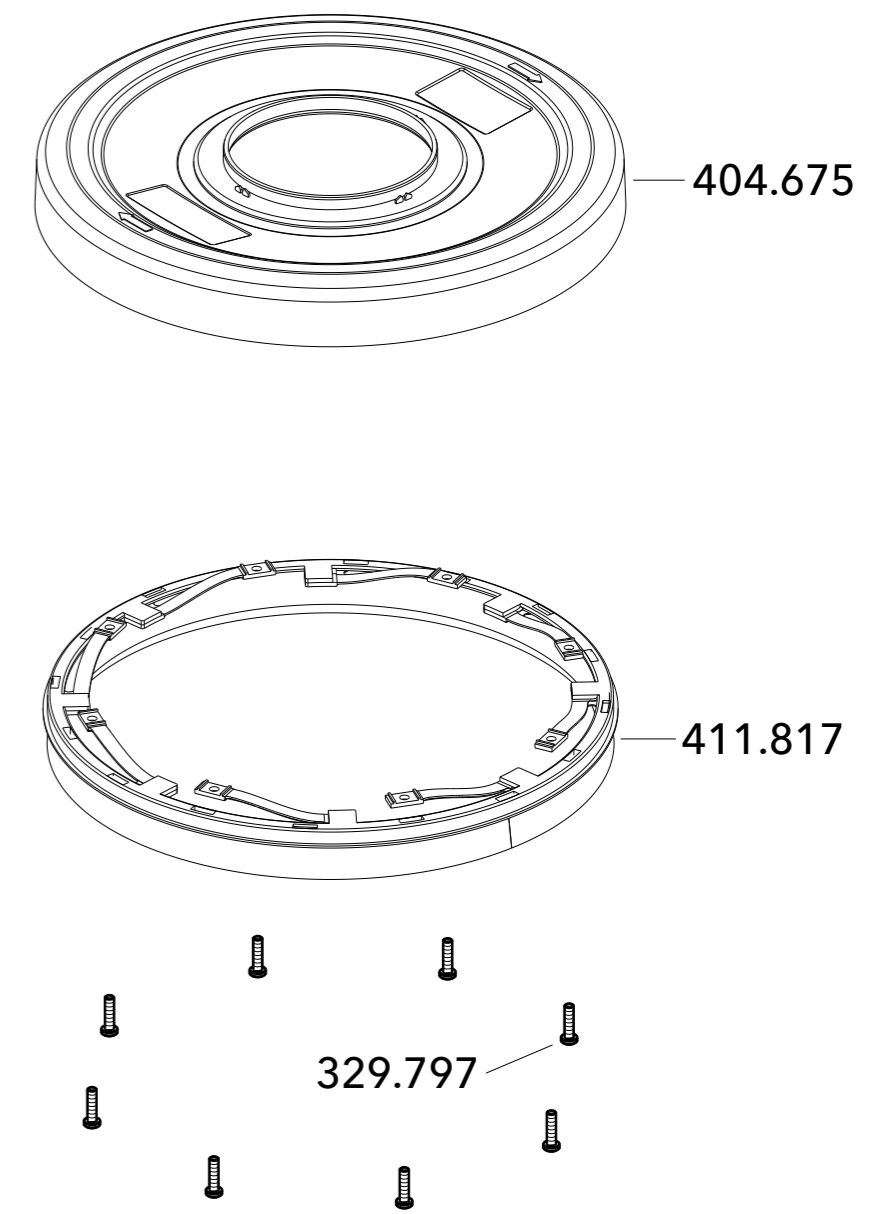

MH-T 290x290

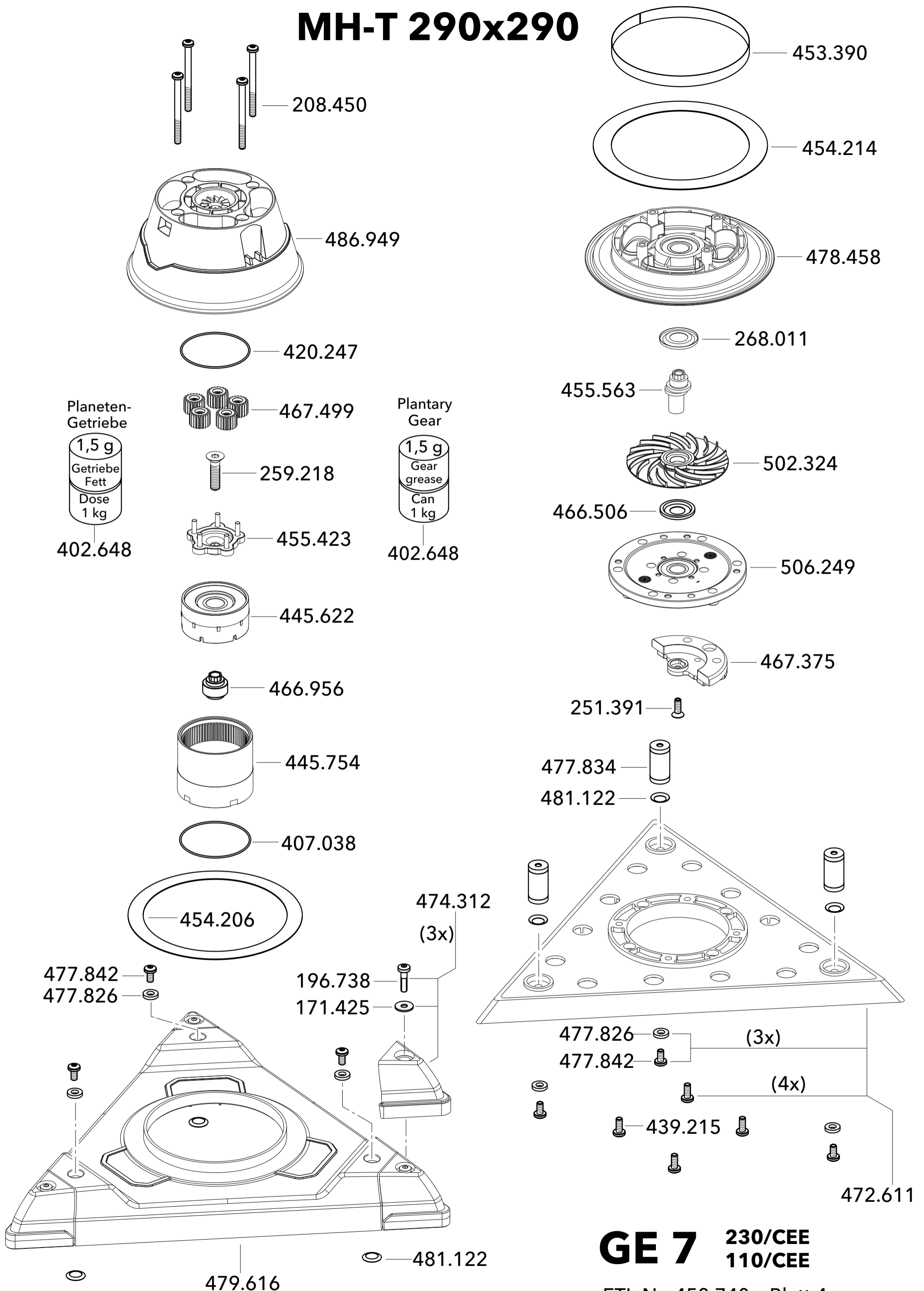

**GE 7 230/CEE
110/CEE**

ETL-Nr. 458.740 Blatt 4
Stand 05-2021

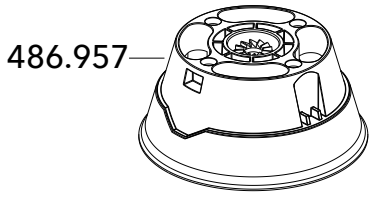
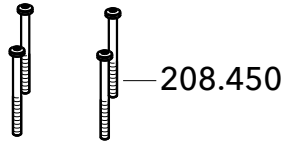

MH-X D225

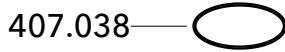
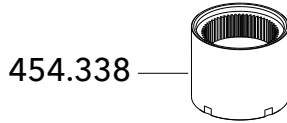
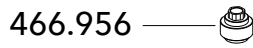
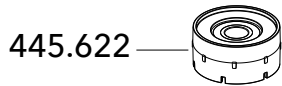
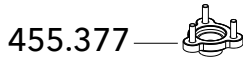
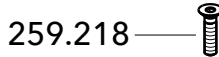
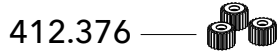
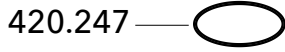

Planeten-
Getriebe



402.648

Planetary
Gear

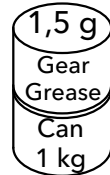

402.648

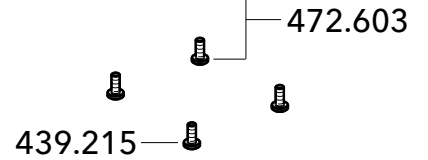
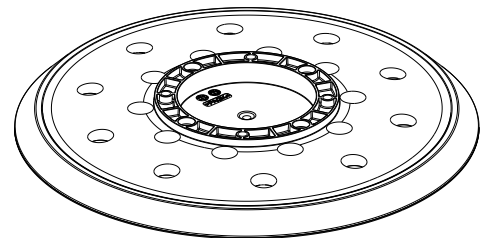
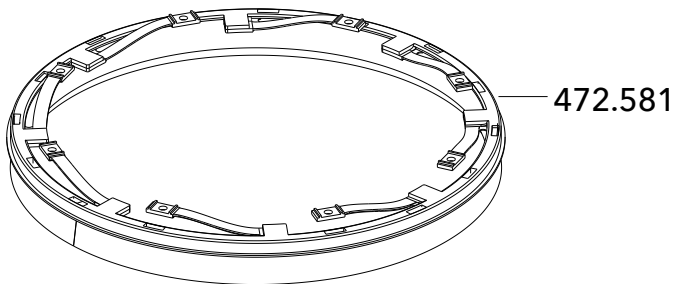
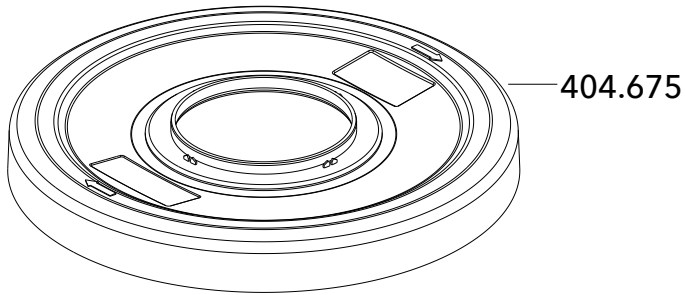
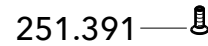
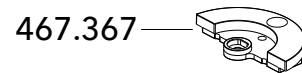
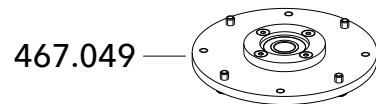
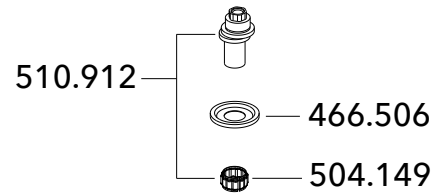
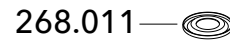
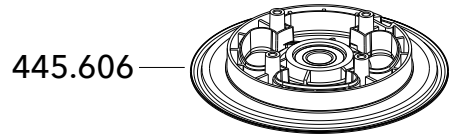

GE 7 230/CEE
110/CEE

ETL-Nr. 458.740 Blatt 5
Stand 02-2021